

# Clever Concept for a Brilliant Bath

A creative layout yields a one-of-a-kind bathroom big on function, light, and views

BY CHARLES MOORE

**T**he owner of this home—a contractor by trade who was also the project's builder—requested a modern, clean design for his family's new residence on a private, wooded lot off a suburban road in northern Virginia. This master bathroom is an example of our design approach for the entire house.

The high ceiling and bright-white spaces are complemented by simple, elegant hardware and fixtures to create a bathroom that is definitively modern. Large floor-to-ceiling windows provide an immense view of the site and the surrounding woods, as well as an uncontained feeling in the bath that is nothing short of dramatic. Where this new master bath really shines, though, is in the arrangement of its plan. All of the typical fixtures one would expect in a master bathroom are organized in a somewhat atypical fashion in this space, and the impact is substantial.

Charles Moore, AIA, is an architect in Alexandria, Va. ([moorearch.com](http://moorearch.com)).



Water closets aren't typical in contemporary bathrooms. In this bath, however, a **water closet** is positioned in the corner away from the windows, where it is buffered from the view by the vanity and shower to provide absolute privacy in the wide-open space.



Instead of a wall, frosted glass separates the double vanity from the **open-ended shower**, allowing the shower area to be drenched in natural light without sacrificing privacy. The shower has removable teak floor panels that suggest the experience of outdoor bathing.



The **custom teak vanity** is suspended beneath a Caesarstone Blizzard top with dual Kraus sinks and faucets. To accommodate the large glass partition, mirrors are attached to poles that are anchored to the ceiling and vanity. Three teardrop pendants help to illuminate the entire arrangement.

## PLANNED FOR ACCESS

The floor plan is arranged so that the shower, vanity, and tub areas all have appropriate, if not equal, access to the daylight and the views provided by the large wall of windows. A 360° circulation path encompasses the bathroom, completely integrating the bath into the master suite.

0 2 4 8 ft.

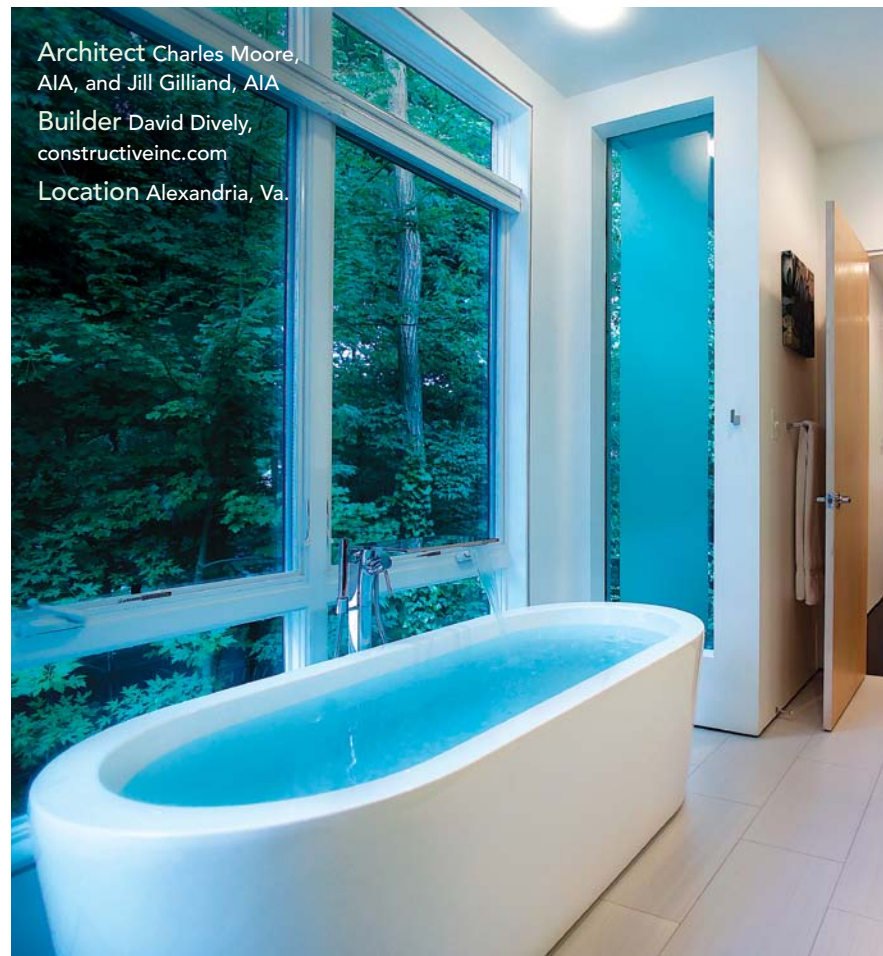
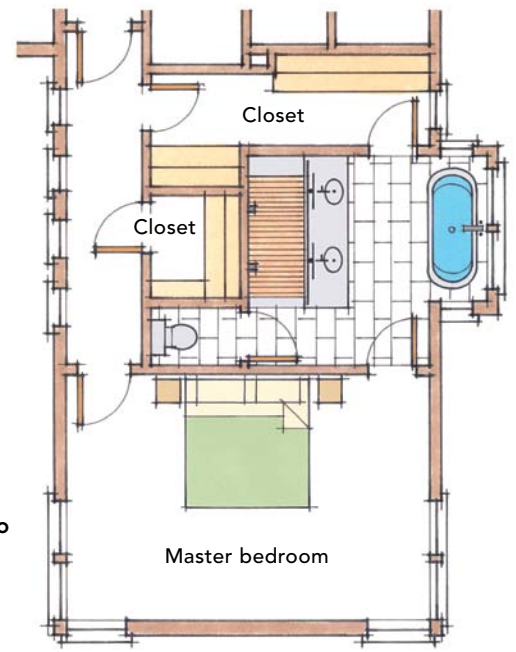

Architect Charles Moore, AIA, and Jill Gilliland, AIA  
 Builder David Dively, constructiveinc.com  
 Location Alexandria, Va.

A **deep soaking tub** is set within a bump-out wrapped on three sides by large expanses of glass, which creates the surreal sense of bathing amid the trees. The view into the bath is controlled with frosted glass and with blinds that look like part of the window mullion when retracted.