

An 1850s home is revived and reconfigured with a modern floor plan

BY SHAWN HARRIS



A Greek Revival



Bold moves. As with many remodels, improving this home's function meant finding a way to connect the kitchen with the living room. To get this done, we did two big things: removed the home's two masonry chimneys, allowing more flexibility in the rooms on both floors, and opened up the load-bearing wall between the original entry and living room using a steel I-beam.

The original portion of this quaint Rhode Island home was built in the mid 1800s. The one-and-a-half-story Greek-revival cottage featured a stone foundation, clapboard siding, well-proportioned exterior trim, and 6-over-6 double-hung windows on the first floor with fixed windows installed in the frieze board beneath the traditional roofline. In the 1900s, the house was added onto—twice. A single-story addition on the back side was eventually built up into a two-story addition that unfortunately missed the mark of the original home's character. Instead, the two additions combined for a tall, narrow, and bland mass.

In all that time, the house had just three owners. When our clients Daniel Heyman and Vincent Renou found it, the house had fallen into a state of disrepair after sitting empty on the market for months. Immediately recognizing its potential, they began the transformation.

Like most homes of that period, the floor plan consisted of small, isolated rooms on the first floor and barely usable second-floor bedrooms with only enough height to stand near the center of the room. With the clients' input, we modernized the floor plan and updated the entire house. Our intention was to make a clear distinction between the historic character of the original home and the spaces that were added later, improving function and performance along the way. □

Shawn Harris is a founder of Sixteen On Center, a design-build firm in Tiverton, R.I. Photos by Nat Rea.



ONLINE EXCLUSIVES
For more on this project, visit
FineHomebuilding.com/houses.

Alterations meet authenticity. We made a clear distinction between the original house and the additions. The clapboard siding, trim details, and first-floor double-hung windows were repaired, but left to their original character. The second-floor windows were upgraded to operable units, and we added a south-facing photovoltaic array.



is Born Again

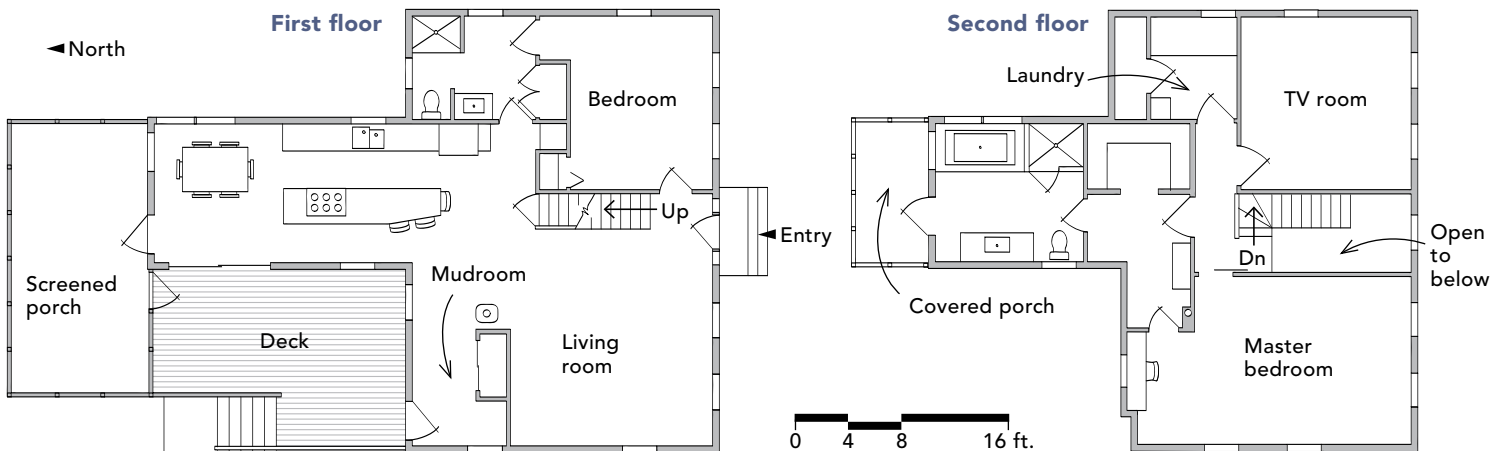

MAKING THE MASTER SUITE WORK

We changed the second-floor circulation by moving the door to the second bedroom and eliminating a good portion of the hall. The new master bath provided a unique opportunity. Because we had 20 ft. under the addition's roof to work with, we were able to create a spacious bath with a covered porch on the back of the house.

SPECS

- Bedrooms:** 3
- Bathrooms:** 2
- Size:** 2200 sq. ft.
- Location:** Tiverton, R.I.
- Architect/Builder:** Sixteen On Center, sixteenoncenter.com